

Nokia Customer Care NEM-4 Series Transceivers

2 - NEM-4 Parts List

Table of Contents

	Page No
Exploded View of NEM-4	3
Mechanical Parts of NEM-4	4
Soldering Components (only for level 2)	5
Variant Parts	6
Swap Units	6
Service Tools	7
Parts List (NEM-4)	8

Exploded View of NEM-4

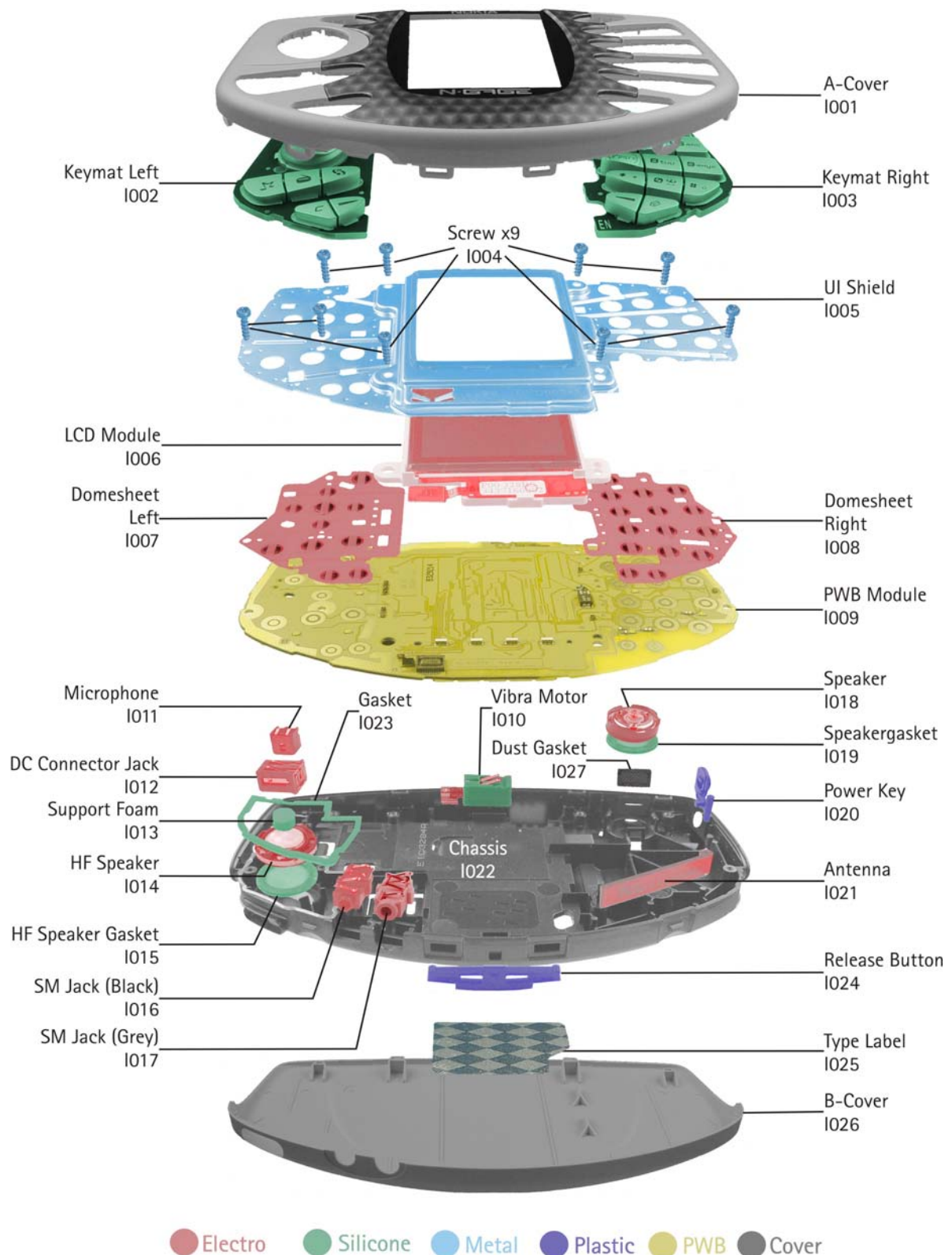

Mechanical Parts of NEM-4

ITEM/ CIRCUIT REF.	QTY	PART NO	PART NAME
I001	1	XXXXXXX	A-COVER ASSY
	1	XXXXXXX	KEYMAT ASSY LEFT&RIGHT
I002	1	-	KEYMAT LEFT
I003	1	-	KEYMAT RIGHT
I004	9	6290107	SCREWS 1.8X7 T6 PLUS
I005	1	9517211	UI SHIELD ASSY
I006	1	4850325	LCD MODULE
	1	9790740	DOMESHEET LEFT&RIGHT
I007	1	-	DOMESHEET LEFT
I008	1	-	DOMESHEET RIGHT
I009	1	-	PWB MODULE
I010	1	6800057	VIBRA MOTOR
I011	1	5140277	MICROPHONE
I012	1	5400243	DC CONNECTOR JACK
I013	1	9470430	SUPPORT FOAM
I014	1	5140253	HF SPEAKER
I015	1	9470297	HF SPEAKER GASKET
I016	1	5400121	SM JACK (COLOUR IS BLACK)
I017	1	5400305	SM JACK (COLOUR IS GREY)
I018	1	5140233	SPEAKER&SPRING
I019	1	9470298	SPEAKERGASKET
I020	1	9790729	POWER KEY
I021	1	0660299	ANTENNA
	1	-	CHASSIS & GASKET
I022	1	-	CHASSIS

ITEM/ CIRCUIT REF.	QTY	PART NO	PART NAME
I023	1	9470472	GASKET
I024	1	9452569	RELEASE BUTTON
I025	1	-	LABEL
I026	1	XXXXXXX	B-COVER
I027	1	9470420	DUST GASKET

Soldering Components (only for level 2)

ITEM/ CIRCUIT REF.	QTY	PART NO	PART NAME
F381		5119019	SM FUSE F 1.5A 32V 0603
S130		5209001	SM SW TACT SPST 12V 50MA SIDE KEY
V140		4864331	LED CL191TD3CDT 605NM >83MCD 0603
V143		4864331	LED CL191TD3CDT 605NM >83MCD 0603
V144		4864331	LED CL191TD3CDT 605NM >83MCD 0603
V145		4864331	LED CL191TD3CDT 605NM >83MCD 0603
V146		4864331	LED CL191TD3CDT 605NM >83MCD 0603
V147		4864331	LED CL191TD3CDT 605NM >83MCD 0603
V148		4864331	LED CL191TD3CDT 605NM >83MCD 0603
V149		4864331	LED CL191TD3CDT 605NM >83MCD 0603
V151		4864427	LED CL270SYG GRN>20MCD 90DEG 0603
V153		4864331	LED CL191TD3CDT 605NM >83MCD 0603
V160		4860501	LED CL430SWD ** RESERVED R0919 **
V161		4860501	LED CL430SWD ** RESERVED R0919 **
V162		4860501	LED CL430SWD ** RESERVED R0919 **
V163		4860501	LED CL430SWD ** RESERVED R0919 **

Variant Parts

ITEM CIRCUIT REF.	QTY	PART NO	PART NAME
I001		9458550	A-COVER ASSY SILVER
I001		9459014	A-COVER ASSY GREY
-		9791219	KEYMAT ASSEMBLY LEFT&RIGHT LATIN
-		9791220	KEYMAT ASSEMBLY LEFT&RIGHT GREEK
-		9791221	KEYMAT ASSEMBLY LEFT&RIGHT RUSSIAN
I026		9452571	B-COVER PAINTED SILVER
I026		9453121	B-COVER PAINTED N.GREEN
I026		9459944	B-COVER GREY

Swap Units

	QTY	PART NO	PART NAME
		0050484	N-GAGE SWAP ENGINE RUSSIA
		0050485	N-GAGE SWAP ENGINE UKRAINE
		0050478	N-GAGE SWAP ENGINE FRANCE
		0050480	N-GAGE SWAP ENGINE TURKEY
		0050481	N-GAGE SWAP ENGINE POLAND
		0050477	N-GAGE SWAP ENGINE E&A
		0050482	N-GAGE SWAP ENGINE CZECH
		0050483	N-GAGE SWAP ENGINE SOUTH AFRICA

Service Tools

TYPE	QTY	PART NO	PART NAME
		0080541	FLS-4S SALES PACK E&A (INCLUSIVE 0680032)
		0680032	UNIV. POWERSUPPLY ACF-8
ACCESSORY		0273558	BL-5C BATTERY PACK LI-IO 850 MAH
ACCESSORY		0272169	AC TRAVEL CHARGER ACP-8E (EURO)
ACCESSORY		0272172	AC TRAVEL CHARGER ACP-8X (UK)
ACCESSORY		0271467	HDC-5 HEADSET
ACCESSORY		0630465	DKE-2 MINI-B USB CABLE
ACCESSORY		0630464	ADE-2 AUDIO LINE IN CABLE
ACCESSORY		0630463	ADA-2 AUDIO ADAPTER CABLE
		0770565	FLA-41 POS FLASH ADAPTER
		0770773	SS-17 DOMESHEET ASSEMBLY JIG
		0730218	XCS-1 SERVICE CABLE
LEVEL 2 ONLY		0770542	RJ-10 SOLDERING JIG
		0770431	SRT-6 OPENING TOOL
		0770450	FLA-41 TESTPINS (10 PCS)

Parts List (NEM-4)

Item	Code	Side	X	Y	Type	Description and value			
A001	9517209	Bottom	W	8	SHIELD_DMC05205	RF-SHIELD CAN RF DMC05205 NEM-4	~	~	~
A002	9517207	Bottom	P	4	SHIELD_DMC05192	RF-SHIELD CAN PA DMC05192 NEM-4	~	~	~
A300	9517210	Bottom	H	6	SHIELD_DMC05191	RF-SHIELD CAN DMC05191 NEM-4	~	~	~
A500	9517208	Bottom	P	9	SHIELD_DMC05193	RF-SHIELD CAN REG DMC05193 NEM-4	~	~	~
A510	9517206	Bottom	P	6	SHIELD_DMC05190	RF-SHIELD CAN AMAD DMC05190 NEM-4	~	~	~
B190	4510303	Bottom	O	10	CRYSTAL_FC_255	CRYSTAL 32.768KHZ+- 20PPM 12.5PF	32.768kHz	~	~
B550	4510407	Bottom	O	3	CRYSTAL_NX5032G A	SMCRYST 12MHZ +-50PPM 8PF	12MHz	~	~
B601	4510337	Bottom	W	6	CRYSTAL_TSX_8A	CRYSTAL 26.0MHZ+-8PPM CL=15.5	26MHz	~	~
C001	2320552	Bottom	J	2	0402C	Chipcap 5% NPO	47p	50V	normal,-5%,5%
C002	2320552	Bottom	J	2	0402C	Chipcap 5% NPO	47p	50V	normal,-5%,5%
C004	2320481	Bottom	G	4	0603C	CHIPCAP X5R 1U K 6V3 0603	1u0	6.3V	normal,- 10%,10%
C005	2613025	Bottom	F	4	TANT_267_B	CHIPCAP 220U M 2.5V 3.5X2.8X1.9	220u_2.5V	2.5V	normal,- 20%,20%
C006	2613025	Bottom	E	4	TANT_267_B	CHIPCAP 220U M 2.5V 3.5X2.8X1.9	220u_2.5V	2.5V	normal,- 20%,20%
C007	2320805	Bottom	E	5	0402C	CHIPCAP X5R 100N K 10V 0402	100n	10V	normal,- 10%,10%
C008	2320143	Bottom	K	4	0402C	Chipcap X5R 10% 6.3V 0402	220n	6.3V	normal,- 10%,10%
C009	2320764	Bottom	O	11	0402C	Chipcap X7R 10% 25V 0402	6n8	25V	normal,- 10%,10%
C010	2320764	Bottom	L	4	0402C	Chipcap X7R 10% 25V 0402	6n8	25V	normal,- 10%,10%
C011	2320584	Bottom	D	3	0402C	Chipcap 5% X7R	1n0	50V	normal,-5%,5%
C012	2320584	Bottom	E	3	0402C	Chipcap 5% X7R	1n0	50V	normal,-5%,5%
C013	2320584	Bottom	D	3	0402C	Chipcap 5% X7R	1n0	50V	normal,-5%,5%
C014	2320584	Bottom	D	4	0402C	Chipcap 5% X7R	1n0	50V	normal,-5%,5%
C015	2320778	Bottom	C	7	0402C	Chipcap X7R 10% 16V 0402	10n	16V	normal,- 10%,10%
C016	2320785	Bottom	D	6	0402C	chipcap x7r 47n k 10v 0402	47n	10V	normal,- 10%,10%
C017	2320481	Bottom	F	6	0603C	CHIPCAP X5R 1U K 6V3 0603	1u0	6.3V	normal,- 10%,10%
C018	2320481	Bottom	F	6	0603C	CHIPCAP X5R 1U K 6V3 0603	1u0	6.3V	normal,- 10%,10%
C019	2320481	Bottom	F	5	0603C	CHIPCAP X5R 1U K 6V3 0603	1u0	6.3V	normal,- 10%,10%
C020	2320481	Bottom	F	5	0603C	CHIPCAP X5R 1U K 6V3 0603	1u0	6.3V	normal,- 10%,10%
C021	2320544	Bottom	N	10	0402C	Chipcap 5% NPO	22p	50V	normal,-5%,5%
C022	2320536	Bottom	C	7	0402C	Chipcap 5% NPO	10p	50V	normal,-5%,5%
C023	2320536	Bottom	C	7	0402C	Chipcap 5% NPO	10p	50V	normal,-5%,5%
C024	2320536	Bottom	S	12	0402C	Chipcap 5% NPO	10p	50V	normal,-5%,5%

Item	Code	Side	X	Y	Type	Description and value			
C025	2320536	Bottom	S	13	0402C	Chipcap 5% NPO	10p	50V	normal,-5%,5%
C026	2320633	Bottom	I	4	0402C	CHIPCAP NPO 220P J 25V 0402	220p	25V	normal,-5%,5%
C027	2320633	Bottom	I	4	0402C	CHIPCAP NPO 220P J 25V 0402	220p	25V	normal,-5%,5%
C028	2320552	Bottom	N	11	0402C	Chipcap 5% NPO	47p	50V	normal,-5%,5%
C029	2320552	Bottom	N	11	0402C	Chipcap 5% NPO	47p	50V	normal,-5%,5%
C033	2320536	Bottom	N	12	0402C	Chipcap 5% NPO	10p	50V	normal,-5%,5%
C034	2320536	Bottom	N	12	0402C	Chipcap 5% NPO	10p	50V	normal,-5%,5%
C035	2320805	Bottom	N	11	0402C	CHIPCAP X5R 100N K 10V 0402	100n	10V	normal,- 10%,10%
C036	2320633	Bottom	I	4	0402C	CHIPCAP NPO 220P J 25V 0402	220p	25V	normal,-5%,5%
C038	2320552	Bottom	O	11	0402C	Chipcap 5% NPO	47p	50V	normal,-5%,5%
C039	2320536	Bottom	O	11	0402C	Chipcap 5% NPO	10p	50V	normal,-5%,5%
C040	2320752	Bottom	F	5	0402C	Chipcap X7R 10% 50V 0402	2n2	50V	normal,- 10%,10%
C041	2320752	Bottom	F	6	0402C	Chipcap X7R 10% 50V 0402	2n2	50V	normal,- 10%,10%
C100	2320805	Bottom	L	7	0402C	CHIPCAP X5R 100N K 10V 0402	100n	10V	normal,- 10%,10%
C101	2320805	Bottom	M	7	0402C	CHIPCAP X5R 100N K 10V 0402	100n	10V	normal,- 10%,10%
C102	2320805	Bottom	K	10	0402C	CHIPCAP X5R 100N K 10V 0402	100n	10V	normal,- 10%,10%
C105	2320805	Bottom	J	9	0402C	CHIPCAP X5R 100N K 10V 0402	100n	10V	normal,- 10%,10%
C107	2320805	Bottom	K	7	0402C	CHIPCAP X5R 100N K 10V 0402	100n	10V	normal,- 10%,10%
C108	2320805	Bottom	K	7	0402C	CHIPCAP X5R 100N K 10V 0402	100n	10V	normal,- 10%,10%
C112	2320805	Bottom	J	10	0402C	CHIPCAP X5R 100N K 10V 0402	100n	10V	normal,- 10%,10%
C113	2320805	Bottom	L	10	0402C	CHIPCAP X5R 100N K 10V 0402	100n	10V	normal,- 10%,10%
C114	2320805	Bottom	L	7	0402C	CHIPCAP X5R 100N K 10V 0402	100n	10V	normal,- 10%,10%
C115	2320805	Bottom	K	7	0402C	CHIPCAP X5R 100N K 10V 0402	100n	10V	normal,- 10%,10%
C118	2320778	Bottom	K	7	0402C	Chipcap X7R 10% 16V 0402	10n	16V	normal,- 10%,10%
C119	2320805	Bottom	M	10	0402C	CHIPCAP X5R 100N K 10V 0402	100n	10V	normal,- 10%,10%
C122	2320805	Bottom	K	7	0402C	CHIPCAP X5R 100N K 10V 0402	100n	10V	normal,- 10%,10%
C123	2320805	Bottom	J	7	0402C	CHIPCAP X5R 100N K 10V 0402	100n	10V	normal,- 10%,10%
C134	2320783	Bottom	K	12	0402C	CHIPCAP X7R 33N K 10V 0402	33n	10V	normal,- 10%,10%
C135	2310793	Bottom	K	12	0805C	CHIPCAP X5R 2U2 K 10V 0805	2u2	10V	normal,- 10%,10%
C136	2320548	Top	T	4	0402C	Chipcap 5% NPO	33p	50V	normal,-5%,5%
C137	2320548	Top	T	4	0402C	Chipcap 5% NPO	33p	50V	normal,-5%,5%
C138	2320548	Top	X	6	0402C	Chipcap 5% NPO	33p	50V	normal,-5%,5%

Item	Code	Side	X	Y	Type	Description and value			
C139	2320548	Top	U	4	0402C	Chipcap 5% NPO	33p	50V	normal,-5%,5%
C140	2320805	Bottom	J	2	0402C	CHIPCAP X5R 100N K 10V 0402	100n	10V	normal,-10%,10%
C141	2320805	Bottom	J	2	0402C	CHIPCAP X5R 100N K 10V 0402	100n	10V	normal,-10%,10%
C142	2320548	Top	W	6	0402C	Chipcap 5% NPO	33p	50V	normal,-5%,5%
C143	2320548	Top	U	4	0402C	Chipcap 5% NPO	33p	50V	normal,-5%,5%
C150	2320604	Bottom	L	12	0402C	Chipcap 5% NPO	18p	50V	normal,-5%,5%
C151	2320552	Bottom	L	12	0402C	Chipcap 5% NPO	47p	50V	normal,-5%,5%
C164	2310037	Bottom	R	11	0805C	CHIPCAP X5R 10U M 6V3 0805	10U	6V3	normal,-20%,20%
C169	2320481	Bottom	S	11	0603C	CHIPCAP X5R 1U K 6V3 0603	1u0	6.3V	normal,-10%,10%
C171	2320536	Bottom	J	7	0402C	Chipcap 5% NPO	10p	50V	normal,-5%,5%
C173	2320481	Bottom	R	11	0603C	CHIPCAP X5R 1U K 6V3 0603	1u0	6.3V	normal,-10%,10%
C174	2320481	Bottom	S	11	0603C	CHIPCAP X5R 1U K 6V3 0603	1u0	6.3V	normal,-10%,10%
C182	2320536	Bottom	Q	11	0402C	Chipcap 5% NPO	10p	50V	normal,-5%,5%
C190	2320481	Bottom	P	8	0603C	CHIPCAP X5R 1U K 6V3 0603	1u0	6.3V	normal,-10%,10%
C191	2320778	Bottom	P	9	0402C	Chipcap X7R 10% 16V 0402	10n	16V	normal,-10%,10%
C192	2320744	Bottom	P	8	0402C	Chipcap X7R 10% 50V 0402	1n0	50V	normal,-10%,10%
C194	2320481	Bottom	P	9	0603C	CHIPCAP X5R 1U K 6V3 0603	1u0	6.3V	normal,-10%,10%
C196	2320536	Bottom	O	11	0402C	Chipcap 5% NPO	10p	50V	normal,-5%,5%
C197	2320536	Bottom	O	10	0402C	Chipcap 5% NPO	10p	50V	normal,-5%,5%
C198	2320481	Bottom	N	10	0603C	CHIPCAP X5R 1U K 6V3 0603	1u0	6.3V	normal,-10%,10%
C199	2320481	Bottom	P	8	0603C	CHIPCAP X5R 1U K 6V3 0603	1u0	6.3V	normal,-10%,10%
C200	2320481	Bottom	P	9	0603C	CHIPCAP X5R 1U K 6V3 0603	1u0	6.3V	normal,-10%,10%
C201	2320481	Bottom	P	10	0603C	CHIPCAP X5R 1U K 6V3 0603	1u0	6.3V	normal,-10%,10%
C203	2320481	Bottom	P	10	0603C	CHIPCAP X5R 1U K 6V3 0603	1u0	6.3V	normal,-10%,10%
C204	2320481	Bottom	P	11	0603C	CHIPCAP X5R 1U K 6V3 0603	1u0	6.3V	normal,-10%,10%
C205	2320481	Bottom	O	10	0603C	CHIPCAP X5R 1U K 6V3 0603	1u0	6.3V	normal,-10%,10%
C206	2320805	Bottom	H	4	0402C	CHIPCAP X5R 100N K 10V 0402	100n	10V	normal,-10%,10%
C207	2320805	Bottom	H	4	0402C	CHIPCAP X5R 100N K 10V 0402	100n	10V	normal,-10%,10%
C215	2320805	Bottom	N	11	0402C	CHIPCAP X5R 100N K 10V 0402	100n	10V	normal,-10%,10%
C216	2320805	Bottom	M	7	0402C	CHIPCAP X5R 100N K 10V 0402	100n	10V	normal,-10%,10%
C218	2320805	Bottom	L	7	0402C	CHIPCAP X5R 100N K 10V 0402	100n	10V	normal,-10%,10%

Item	Code	Side	X	Y	Type	Description and value			
C219	2320805	Bottom	M	7	0402C	CHIPCAP X5R 100N K 10V 0402	100n	10V	normal,-10%,10%
C223	2320805	Bottom	P	8	0402C	CHIPCAP X5R 100N K 10V 0402	100n	10V	normal,-10%,10%
C224	2320805	Bottom	O	8	0402C	CHIPCAP X5R 100N K 10V 0402	100n	10V	normal,-10%,10%
C226	2320744	Bottom	N	11	0402C	Chipcap X7R 10% 50V 0402	1n0	50V	normal,-10%,10%
C227	2320744	Bottom	P	11	0402C	Chipcap X7R 10% 50V 0402	1n0	50V	normal,-10%,10%
C228	2320744	Bottom	P	11	0402C	Chipcap X7R 10% 50V 0402	1n0	50V	normal,-10%,10%
C230	2320481	Bottom	M	7	0603C	CHIPCAP X5R 1U K 6V3 0603	1u0	6.3V	normal,-10%,10%
C232	2320805	Bottom	N	7	0402C	CHIPCAP X5R 100N K 10V 0402	100n	10V	normal,-10%,10%
C234	2320481	Bottom	M	7	0603C	CHIPCAP X5R 1U K 6V3 0603	1u0	6.3V	normal,-10%,10%
C236	2320481	Bottom	N	7	0603C	CHIPCAP X5R 1U K 6V3 0603	1u0	6.3V	normal,-10%,10%
C240	2320481	Bottom	O	7	0603C	CHIPCAP X5R 1U K 6V3 0603	1u0	6.3V	normal,-10%,10%
C241	2320481	Bottom	P	9	0603C	CHIPCAP X5R 1U K 6V3 0603	1u0	6.3V	normal,-10%,10%
C242	2320481	Bottom	P	10	0603C	CHIPCAP X5R 1U K 6V3 0603	1u0	6.3V	normal,-10%,10%
C243	2320481	Bottom	N	10	0603C	CHIPCAP X5R 1U K 6V3 0603	1u0	6.3V	normal,-10%,10%
C244	2320481	Bottom	O	7	0603C	CHIPCAP X5R 1U K 6V3 0603	1u0	6.3V	normal,-10%,10%
C245	2320481	Bottom	N	10	0603C	CHIPCAP X5R 1U K 6V3 0603	1u0	6.3V	normal,-10%,10%
C246	2320481	Bottom	O	7	0603C	CHIPCAP X5R 1U K 6V3 0603	1u0	6.3V	normal,-10%,10%
C247	2320481	Bottom	P	11	0603C	CHIPCAP X5R 1U K 6V3 0603	1u0	6.3V	normal,-10%,10%
C249	2320481	Bottom	N	10	0603C	CHIPCAP X5R 1U K 6V3 0603	1u0	6.3V	normal,-10%,10%
C251	2320481	Bottom	M	7	0603C	CHIPCAP X5R 1U K 6V3 0603	1u0	6.3V	normal,-10%,10%
C252	2320552	Bottom	P	10	0402C	Chipcap 5% NPO	47p	50V	normal,-5%,5%
C253	2320548	Bottom	U	10	0402C	Chipcap 5% NPO	33p	50V	normal,-5%,5%
C255	2320481	Bottom	M	7	0603C	CHIPCAP X5R 1U K 6V3 0603	1u0	6.3V	normal,-10%,10%
C256	2320481	Bottom	N	7	0603C	CHIPCAP X5R 1U K 6V3 0603	1u0	6.3V	normal,-10%,10%
C257	2320481	Bottom	N	7	0603C	CHIPCAP X5R 1U K 6V3 0603	1u0	6.3V	normal,-10%,10%
C258	2320481	Bottom	P	8	0603C	CHIPCAP X5R 1U K 6V3 0603	1u0	6.3V	normal,-10%,10%
C259	2320481	Bottom	N	7	0603C	CHIPCAP X5R 1U K 6V3 0603	1u0	6.3V	normal,-10%,10%
C260	2320552	Bottom	T	10	0402C	Chipcap 5% NPO	47p	50V	normal,-5%,5%
C261	2310037	Bottom	T	11	0805C	CHIPCAP X5R 10U M 6V3 0805	10U	6V3	normal,-20%,20%

Item	Code	Side	X	Y	Type	Description and value			
C263	2310037	Bottom	S	10	0805C	CHIPCAP X5R 10U M 6V3 0805	10U	6V3	normal,-20%,20%
C264	2320481	Bottom	R	9	0603C	CHIPCAP X5R 1U K 6V3 0603	1u0	6.3V	normal,-10%,10%
C265	2320481	Bottom	Q	9	0603C	CHIPCAP X5R 1U K 6V3 0603	1u0	6.3V	normal,-10%,10%
C266	2310037	Bottom	R	10	0805C	CHIPCAP X5R 10U M 6V3 0805	10U	6V3	normal,-20%,20%
C267	2310037	Bottom	R	10	0805C	CHIPCAP X5R 10U M 6V3 0805	10U	6V3	normal,-20%,20%
C284	2310037	Bottom	S	10	0805C	CHIPCAP X5R 10U M 6V3 0805	10U	6V3	normal,-20%,20%
C286	2320481	Bottom	M	5	0603C	CHIPCAP X5R 1U K 6V3 0603	1u0	6.3V	normal,-10%,10%
C287	2320143	Bottom	M	3	0402C	Chipcap X5R 10% 6.3V 0402	220n	6.3V	normal,-10%,10%
C291	2320481	Bottom	O	2	0603C	CHIPCAP X5R 1U K 6V3 0603	1u0	6.3V	normal,-10%,10%
C292	2320481	Bottom	P	2	0603C	CHIPCAP X5R 1U K 6V3 0603	1u0	6.3V	normal,-10%,10%
C293	2310793	Bottom	N	2	0805C	CHIPCAP X5R 2U2 K 10V 0805	2u2	10V	normal,-10%,10%
C294	2320481	Bottom	O	2	0603C	CHIPCAP X5R 1U K 6V3 0603	1u0	6.3V	normal,-10%,10%
C295	2310037	Bottom	M	5	0805C	CHIPCAP X5R 10U M 6V3 0805	10U	6V3	normal,-20%,20%
C296	2320481	Bottom	L	5	0603C	CHIPCAP X5R 1U K 6V3 0603	1u0	6.3V	normal,-10%,10%
C297	2320481	Bottom	L	6	0603C	CHIPCAP X5R 1U K 6V3 0603	1u0	6.3V	normal,-10%,10%
C298	2320481	Bottom	M	5	0603C	CHIPCAP X5R 1U K 6V3 0603	1u0	6.3V	normal,-10%,10%
C299	2320481	Bottom	M	6	0603C	CHIPCAP X5R 1U K 6V3 0603	1u0	6.3V	normal,-10%,10%
C300	2320481	Bottom	P	7	0603C	CHIPCAP X5R 1U K 6V3 0603	1u0	6.3V	normal,-10%,10%
C301	2320481	Bottom	N	7	0603C	CHIPCAP X5R 1U K 6V3 0603	1u0	6.3V	normal,-10%,10%
C302	2310037	Bottom	O	7	0805C	CHIPCAP X5R 10U M 6V3 0805	10U	6V3	normal,-20%,20%
C306	2610101	Bottom	D	7	TANT_XTE	CHIPTCAP 22U M 6.3V 3.5X2.8X1.9	22u_6.3V	6.3V	normal,-20%,20%
C308	2320778	Bottom	C	8	0402C	Chipcap X7R 10% 16V 0402	10n	16V	normal,-10%,10%
C309	2320560	Bottom	C	8	0402C	Chipcap 5% NP0	100p	50V	normal,-5%,5%
C310	2320805	Bottom	I	10	0402C	CHIPCAP X5R 100N K 10V 0402	100n	10V	normal,-10%,10%
C311	2320779	Bottom	J	10	0603_BLM	CHIPCAP X7R 100N K 16V 0603	100n	16V	normal,-10%,10%
C312	2320805	Bottom	I	10	0402C	CHIPCAP X5R 100N K 10V 0402	100n	10V	normal,-10%,10%
C313	2320481	Bottom	P	7	0603C	CHIPCAP X5R 1U K 6V3 0603	1u0	6.3V	normal,-10%,10%
C314	2320805	Bottom	K	10	0402C	CHIPCAP X5R 100N K 10V 0402	100n	10V	normal,-10%,10%

Item	Code	Side	X	Y	Type	Description and value			
C315	2320779	Bottom	L	10	0603_BLM	CHIPCAP X7R 100N K 16V 0603	100n	16V	normal,-10%,10%
C316	2320805	Bottom	M	10	0402C	CHIPCAP X5R 100N K 10V 0402	100n	10V	normal,-10%,10%
C317	2312243	Bottom	I	10	0805C	CHIPCAP X5R 4U7 K 6V3 0805	4u7	6V3	normal,-10%,10%
C318	2320778	Bottom	I	7	0402C	Chipcap X7R 10% 16V 0402	10n	16V	normal,-10%,10%
C319	2320778	Bottom	I	10	0402C	Chipcap X7R 10% 16V 0402	10n	16V	normal,-10%,10%
C320	2320805	Bottom	J	10	0402C	CHIPCAP X5R 100N K 10V 0402	100n	10V	normal,-10%,10%
C321	2320805	Bottom	J	10	0402C	CHIPCAP X5R 100N K 10V 0402	100n	10V	normal,-10%,10%
C322	2320805	Bottom	M	10	0402C	CHIPCAP X5R 100N K 10V 0402	100n	10V	normal,-10%,10%
C323	2320778	Bottom	I	10	0402C	Chipcap X7R 10% 16V 0402	10n	16V	normal,-10%,10%
C324	2320779	Bottom	N	11	0603_BLM	CHIPCAP X7R 100N K 16V 0603	100n	16V	normal,-10%,10%
C325	2320805	Bottom	L	10	0402C	CHIPCAP X5R 100N K 10V 0402	100n	10V	normal,-10%,10%
C330	2320783	Bottom	O	10	0402C	CHIPCAP X7R 33N K 10V 0402	33n	10V	normal,-10%,10%
C331	2320783	Bottom	N	10	0402C	CHIPCAP X7R 33N K 10V 0402	33n	10V	normal,-10%,10%
C332	2320544	Bottom	D	12	0402C	Chipcap 5% NPO	22p	50V	normal,-5%,5%
C333	2320805	Bottom	N	10	0402C	CHIPCAP X5R 100N K 10V 0402	100n	10V	normal,-10%,10%
C334	2320633	Bottom	C	7	0402C	CHIPCAP NPO 220P J 25V 0402	220p	25V	normal,-5%,5%
C336	2320785	Bottom	D	6	0402C	chipcap x7r 47n k 10v 0402	47n	10V	normal,-10%,10%
C338	2320552	Bottom	C	7	0402C	Chipcap 5% NPO	47p	50V	normal,-5%,5%
C339	2320481	Bottom	C	6	0603C	CHIPCAP X5R 1U K 6V3 0603	1u0	6.3V	normal,-10%,10%
C340	2320544	Bottom	C	7	0402C	Chipcap 5% NPO	22p	50V	normal,-5%,5%
C341	2320552	Bottom	C	7	0402C	Chipcap 5% NPO	47p	50V	normal,-5%,5%
C342	2320805	Bottom	C	9	0402C	CHIPCAP X5R 100N K 10V 0402	100n	10V	normal,-10%,10%
C343	2320544	Bottom	I	5	0402C	Chipcap 5% NPO	22p	50V	normal,-5%,5%
C344	2320544	Bottom	I	5	0402C	Chipcap 5% NPO	22p	50V	normal,-5%,5%
C345	2320783	Bottom	O	11	0402C	CHIPCAP X7R 33N K 10V 0402	33n	10V	normal,-10%,10%
C346	2320783	Bottom	O	11	0402C	CHIPCAP X7R 33N K 10V 0402	33n	10V	normal,-10%,10%
C347	2320544	Bottom	I	3	0402C	Chipcap 5% NPO	22p	50V	normal,-5%,5%
C348	2320552	Bottom	N	11	0402C	Chipcap 5% NPO	47p	50V	normal,-5%,5%
C350	2320778	Bottom	O	11	0402C	Chipcap X7R 10% 16V 0402	10n	16V	normal,-10%,10%
C351	2320778	Bottom	O	11	0402C	Chipcap X7R 10% 16V 0402	10n	16V	normal,-10%,10%
C352	2320633	Bottom	H	4	0402C	CHIPCAP NPO 220P J 25V 0402	220p	25V	normal,-5%,5%

Item	Code	Side	X	Y	Type	Description and value			
C353	2320633	Bottom	H	4	0402C	CHIPCAP NP0 220P J 25V 0402	220p	25V	normal,-5%,5%
C354	2320552	Bottom	S	12	0402C	Chipcap 5% NP0	47p	50V	normal,-5%,5%
C355	2320544	Bottom	S	12	0402C	Chipcap 5% NP0	22p	50V	normal,-5%,5%
C356	2320552	Bottom	S	13	0402C	Chipcap 5% NP0	47p	50V	normal,-5%,5%
C357	2320805	Bottom	O	11	0402C	CHIPCAP X5R 100N K 10V 0402	100n	10V	normal,-10%,10%
C358	2320764	Bottom	O	10	0402C	Chipcap X7R 10% 25V 0402	6n8	25V	normal,-10%,10%
C359	2320764	Bottom	N	10	0402C	Chipcap X7R 10% 25V 0402	6n8	25V	normal,-10%,10%
C382	2320536	Bottom	Q	13	0402C	Chipcap 5% NP0	10p	50V	normal,-5%,5%
C383	2320552	Bottom	Q	13	0402C	Chipcap 5% NP0	47p	50V	normal,-5%,5%
C386	2320481	Bottom	Q	13	0603C	CHIPCAP X5R 1U K 6V3 0603	1u0	6.3V	normal,-10%,10%
C387	2320778	Bottom	D	8	0402C	Chipcap X7R 10% 16V 0402	10n	16V	normal,-10%,10%
C388	2318003	Bottom	D	8	0805C	CHIPCAP X5R 1U0 K 16V 0805	1u0	16V	normal,-10%,10%
C430	2320481	Bottom	G	6	0603C	CHIPCAP X5R 1U K 6V3 0603	1u0	6.3V	normal,-10%,10%
C431	2320481	Bottom	E	11	0603C	CHIPCAP X5R 1U K 6V3 0603	1u0	6.3V	normal,-10%,10%
C432	2320481	Bottom	G	12	0603C	CHIPCAP X5R 1U K 6V3 0603	1u0	6.3V	normal,-10%,10%
C470	2320481	Bottom	E	12	0603C	CHIPCAP X5R 1U K 6V3 0603	1u0	6.3V	normal,-10%,10%
C471	2320805	Bottom	J	5	0402C	CHIPCAP X5R 100N K 10V 0402	100n	10V	normal,-10%,10%
C472	2310793	Bottom	E	13	0805C	CHIPCAP X5R 2U2 K 10V 0805	2u2	10V	normal,-10%,10%
C473	2320778	Bottom	F	13	0402C	Chipcap X7R 10% 16V 0402	10n	16V	normal,-10%,10%
C475	2320544	Bottom	J	5	0402C	Chipcap 5% NP0	22p	50V	normal,-5%,5%
C476	2320544	Bottom	J	5	0402C	Chipcap 5% NP0	22p	50V	normal,-5%,5%
C477	2320544	Bottom	H	5	0402C	Chipcap 5% NP0	22p	50V	normal,-5%,5%
C478	2320805	Bottom	F	13	0402C	CHIPCAP X5R 100N K 10V 0402	100n	10V	normal,-10%,10%
C488	2320544	Bottom	J	4	0402C	Chipcap 5% NP0	22p	50V	normal,-5%,5%
C500	2320805	Bottom	K	2	0402C	CHIPCAP X5R 100N K 10V 0402	100n	10V	normal,-10%,10%
C501	2320546	Bottom	L	4	0402C	Chipcap 5% NP0	27p	50V	normal,-5%,5%
C502	2320552	Bottom	L	4	0402C	Chipcap 5% NP0	47p	50V	normal,-5%,5%
C503	2320760	Bottom	L	2	0402C	Chipcap X7R 10% 25V 0402	4n7	25V	normal,-10%,10%
C504	2320783	Bottom	L	2	0402C	CHIPCAP X7R 33N K 10V 0402	33n	10V	normal,-10%,10%
C505	2320481	Bottom	L	2	0603C	CHIPCAP X5R 1U K 6V3 0603	1u0	6.3V	normal,-10%,10%
C508	2321007	Bottom	K	3	0402C	CERCAP X7R 22N K 16V 0402	22n	16V	normal,-10%,10%
C509	2321007	Bottom	K	3	0402C	CERCAP X7R 22N K 16V 0402	22n	16V	normal,-10%,10%

Item	Code	Side	X	Y	Type	Description and value			
C511	2320778	Bottom	K	2	0402C	Chipcap X7R 10% 16V 0402	10n	16V	normal,-10%,10%
C512	2320778	Bottom	K	2	0402C	Chipcap X7R 10% 16V 0402	10n	16V	normal,-10%,10%
C513	2320785	Bottom	K	2	0402C	chipcap x7r 47n k 10v 0402	47n	10V	normal,-10%,10%
C514	2320805	Bottom	K	4	0402C	CHIPCAP X5R 100N K 10V 0402	100n	10V	normal,-10%,10%
C515	2320805	Bottom	K	4	0402C	CHIPCAP X5R 100N K 10V 0402	100n	10V	normal,-10%,10%
C516	2320530	Bottom	L	5	0402C	Chipcap +-0.25pF NPO	5p6	50V	normal,-0.25pF,0.25pF
C517	2320805	Bottom	K	6	0402C	CHIPCAP X5R 100N K 10V 0402	100n	10V	normal,-10%,10%
C518	2320805	Bottom	K	6	0402C	CHIPCAP X5R 100N K 10V 0402	100n	10V	normal,-10%,10%
C519	2320526	Bottom	L	4	0402C	Chipcap +-0.25pF NPO	3p9	50V	normal,-0.25pF,0.25pF
C521	2320584	Bottom	K	7	0402C	Chipcap 5% X7R	1n0	50V	normal,-5%,5%
C522	2320752	Bottom	K	7	0402C	Chipcap X7R 10% 50V 0402	2n2	50V	normal,-10%,10%
C524	2320783	Bottom	K	4	0402C	CHIPCAP X7R 33N K 10V 0402	33n	10V	normal,-10%,10%
C525	2320785	Bottom	K	4	0402C	chipcap x7r 47n k 10v 0402	47n	10V	normal,-10%,10%
C526	2320783	Bottom	K	4	0402C	CHIPCAP X7R 33N K 10V 0402	33n	10V	normal,-10%,10%
C527	2320584	Bottom	K	4	0402C	Chipcap 5% X7R	1n0	50V	normal,-5%,5%
C528	2320785	Bottom	L	4	0402C	chipcap x7r 47n k 10v 0402	47n	10V	normal,-10%,10%
C529	2320785	Bottom	K	4	0402C	chipcap x7r 47n k 10v 0402	47n	10V	normal,-10%,10%
C561	2320778	Bottom	M	5	0402C	Chipcap X7R 10% 16V 0402	10n	16V	normal,-10%,10%
C562	2320778	Bottom	P	4	0402C	Chipcap X7R 10% 16V 0402	10n	16V	normal,-10%,10%
C563	2320778	Bottom	O	6	0402C	Chipcap X7R 10% 16V 0402	10n	16V	normal,-10%,10%
C564	2320778	Bottom	M	3	0402C	Chipcap X7R 10% 16V 0402	10n	16V	normal,-10%,10%
C565	2320778	Bottom	M	3	0402C	Chipcap X7R 10% 16V 0402	10n	16V	normal,-10%,10%
C566	2320778	Bottom	P	5	0402C	Chipcap X7R 10% 16V 0402	10n	16V	normal,-10%,10%
C570	2320778	Bottom	M	4	0402C	Chipcap X7R 10% 16V 0402	10n	16V	normal,-10%,10%
C571	2320778	Bottom	M	5	0402C	Chipcap X7R 10% 16V 0402	10n	16V	normal,-10%,10%
C572	2320778	Bottom	P	4	0402C	Chipcap X7R 10% 16V 0402	10n	16V	normal,-10%,10%
C573	2310037	Bottom	P	5	0805C	CHIPCAP X5R 10U M 6V3 0805	10U	6V3	normal,-20%,20%
C574	2320778	Bottom	P	5	0402C	Chipcap X7R 10% 16V 0402	10n	16V	normal,-10%,10%

Item	Code	Side	X	Y	Type	Description and value			
C575	2310037	Bottom	O	3	0805C	CHIPCAP X5R 10U M 6V3 0805	10U	6V3	normal,-20%,20%
C576	2320778	Bottom	N	6	0402C	Chipcap X7R 10% 16V 0402	10n	16V	normal,-10%,10%
C577	2320778	Bottom	M	4	0402C	Chipcap X7R 10% 16V 0402	10n	16V	normal,-10%,10%
C578	2320778	Bottom	O	6	0402C	Chipcap X7R 10% 16V 0402	10n	16V	normal,-10%,10%
C579	2320778	Bottom	O	6	0402C	Chipcap X7R 10% 16V 0402	10n	16V	normal,-10%,10%
C580	2320778	Bottom	M	4	0402C	Chipcap X7R 10% 16V 0402	10n	16V	normal,-10%,10%
C581	2320778	Bottom	N	3	0402C	Chipcap X7R 10% 16V 0402	10n	16V	normal,-10%,10%
C582	2320778	Bottom	M	4	0402C	Chipcap X7R 10% 16V 0402	10n	16V	normal,-10%,10%
C588	2320778	Bottom	N	2	0402C	Chipcap X7R 10% 16V 0402	10n	16V	normal,-10%,10%
C589	2320778	Bottom	N	1	0402C	Chipcap X7R 10% 16V 0402	10n	16V	normal,-10%,10%
C590	2320778	Bottom	N	2	0402C	Chipcap X7R 10% 16V 0402	10n	16V	normal,-10%,10%
C595	2320805	Bottom	E	10	0402C	CHIPCAP X5R 100N K 10V 0402	100n	10V	normal,-10%,10%
C596	2320540	Bottom	P	2	0402C	Chipcap 5% NPO	15p	50V	normal,-5%,5%
C597	2320540	Bottom	O	2	0402C	Chipcap 5% NPO	15p	50V	normal,-5%,5%
C598	2320544	Bottom	B	7	0402C	Chipcap 5% NPO	22p	50V	normal,-5%,5%
C599	2320778	Bottom	N	2	0402C	Chipcap X7R 10% 16V 0402	10n	16V	normal,-10%,10%
C602	2320546	Bottom	J	7	0402C	Chipcap 5% NPO	27p	50V	normal,-5%,5%
C603	2320744	Bottom	I	7	0402C	Chipcap X7R 10% 50V 0402	1n0	50V	normal,-10%,10%
C604	2320629	Bottom	V	7	0402C	CHIPCAP NPO 1P0 B 50V 0402	1p0	50V	normal,-0.1p,0.1p
C605	2320805	Bottom	V	5	0402C	CHIPCAP X5R 100N K 10V 0402	100n	10V	normal,-10%,10%
C606	2320546	Bottom	V	5	0402C	Chipcap 5% NPO	27p	50V	normal,-5%,5%
C607	2312211	Bottom	V	5	0805C_H1.35	CHIPCAP X5R 3U3 K 6V3 0805	3u3	6V3	normal,-10%,10%
C608	2320516	Bottom	V	7	0402C	Chipcap +-0.25pF NPO	1p5	50V	normal,-0.25pF,0.25pF
C610	2320805	Bottom	W	10	0402C	CHIPCAP X5R 100N K 10V 0402	100n	10V	normal,-10%,10%
C615	2320778	Bottom	W	5	0402C	Chipcap X7R 10% 16V 0402	10n	16V	normal,-10%,10%
C620	2320546	Bottom	W	6	0402C	Chipcap 5% NPO	27p	50V	normal,-5%,5%
C622	2320805	Bottom	V	8	0402C	CHIPCAP X5R 100N K 10V 0402	100n	10V	normal,-10%,10%
C623	2320778	Bottom	X	7	0402C	Chipcap X7R 10% 16V 0402	10n	16V	normal,-10%,10%
C624	2320618	Bottom	X	7	0402C	Chipcap X7R 5% 25V 0402	4n7	25V	normal,-5%,5%
C625	2320481	Bottom	Y	8	0603C	CHIPCAP X5R 1U K 6V3 0603	1u0	6.3V	normal,-10%,10%

Item	Code	Side	X	Y	Type	Description and value			
C626	2320522	Bottom	W	9	0402C	Chipcap +-0.25pF NPO	2p7	50V	normal,- 0.25pF,0.25pF
C627	2312243	Bottom	W	9	0805C	CHIPCAP X5R 4U7 K 6V3 0805	4u7	6V3	normal,- 10%,10%
C628	2320805	Bottom	X	6	0402C	CHIPCAP X5R 100N K 10V 0402	100n	10V	normal,- 10%,10%
C629	2320546	Bottom	X	7	0402C	Chipcap 5% NPO	27p	50V	normal,-5%,5%
C632	2320744	Bottom	V	6	0402C	Chipcap X7R 10% 50V 0402	1n0	50V	normal,- 10%,10%
C633	2320546	Bottom	X	8	0402C	Chipcap 5% NPO	27p	50V	normal,-5%,5%
C634	2320520	Bottom	V	6	0402C	Chipcap +-0.25pF NPO	2p2	50V	normal,- 0.25pF,0.25pF
C635	2320805	Bottom	Y	7	0402C	CHIPCAP X5R 100N K 10V 0402	100n	10V	normal,- 10%,10%
C636	2320596	Bottom	W	5	0402C	Chipcap 5% X7R	3n3	50V	normal,-5%,5%
C640	2320540	Bottom	T	6	0402C	Chipcap 5% NPO	15p	50V	normal,-5%,5%
C641	2320540	Bottom	T	6	0402C	Chipcap 5% NPO	15p	50V	normal,-5%,5%
C706	2320560	Bottom	X	8	0402C	Chipcap 5% NPO	100p	50V	normal,-5%,5%
C707	2322023	Bottom	X	8	0603C	CHIPCAP NPO 2N2 J 16V 0603	2n2	16V	normal,-5%,5%
C710	2321013	Bottom	X	9	0402C	CHIPCAP NPO 270P J 25V 0402	270p	25V	normal,-5%,5%
C711	2420031	Bottom	X	9	0603C	CHIPCAP PPS 2N7 G 16V 0603	2n7	16V	normal,-2%,2%
C712	2320631	Bottom	X	9	0402C	CHIPCAP NPO 180P J 25V 0402	180p	25V	normal,-5%,5%
C715	2320556	Bottom	X	9	0402C	Chipcap 5% NPO	68p	50V	normal,-5%,5%
C716	2320556	Bottom	X	9	0402C	Chipcap 5% NPO	68p	50V	normal,-5%,5%
C717	2320546	Bottom	Y	8	0402C	Chipcap 5% NPO	27p	50V	normal,-5%,5%
C718	2320744	Bottom	X	8	0402C	Chipcap X7R 10% 50V 0402	1n0	50V	normal,- 10%,10%
C721	2320744	Bottom	V	8	0402C	Chipcap X7R 10% 50V 0402	1n0	50V	normal,- 10%,10%
C722	2320540	Bottom	V	8	0402C	Chipcap 5% NPO	15p	50V	normal,-5%,5%
C731	2320546	Bottom	W	8	0402C	Chipcap 5% NPO	27p	50V	normal,-5%,5%
C740	2312211	Bottom	W	9	0805C_H1.35	CHIPCAP X5R 3U3 K 6V3 0805	3u3	6V3	normal,- 10%,10%
C741	2320602	Bottom	W	9	0402C	Chipcap +-0.25pF NPO	4p7	50V	normal,- 0.25pF,0.25pF
C803	2320546	Bottom	S	5	0402C	Chipcap 5% NPO	27p	50V	normal,-5%,5%
C804	2320552	Bottom	T	5	0402C	Chipcap 5% NPO	47p	50V	normal,-5%,5%
C805	2320546	Bottom	T	5	0402C	Chipcap 5% NPO	27p	50V	normal,-5%,5%
C810	2320602	Bottom	R	5	0402C	Chipcap +-0.25pF NPO	4p7	50V	normal,- 0.25pF,0.25pF
C813	2320778	Bottom	R	5	0402C	Chipcap X7R 10% 16V 0402	10n	16V	normal,- 10%,10%
C814	2320548	Bottom	R	5	0402C	Chipcap 5% NPO	33p	50V	normal,-5%,5%
C815	2611753	Bottom	T	7	TANT_TPSW2	CHIPTCAP 33U M 16V 6.0X3.2X1.5	33u_16V	16V	normal,- 20%,20%
C816	2320548	Bottom	Q	5	0402C	Chipcap 5% NPO	33p	50V	normal,-5%,5%
C817	2320602	Bottom	Q	5	0402C	Chipcap +-0.25pF NPO	4p7	50V	normal,- 0.25pF,0.25pF
C818	2320546	Bottom	T	8	0402C	Chipcap 5% NPO	27p	50V	normal,-5%,5%

Item	Code	Side	X	Y	Type	Description and value			
C819	2611753	Top	R	7	TANT_TPSW2	CHIPTCAP 33U M 16V 6.0X3.2X1.5	33u_16V	16V	normal,- 20%,20%
C820	2320546	Bottom	S	8	0402C	Chipcap 5% NPO	27p	50V	normal,-5%,5%
C821	2320518	Bottom	T	8	0402C	Chipcap +-0.25pF NPO	1p8	50V	normal,- 0.25pF,0.25pF
C822	2320546	Bottom	T	8	0402C	Chipcap 5% NPO	27p	50V	normal,-5%,5%
C823	2320629	Bottom	R	5	0402C	CHIPCAP NPO 1P0 B 50V 0402	1p0	50V	normal,- 0.1p,0.1p
C824	2320526	Bottom	T	8	0402C	Chipcap +-0.25pF NPO	3p9	50V	normal,- 0.25pF,0.25pF
C826	2320534	Bottom	S	5	0402C	Chipcap +-0.25pF NPO	8p2	50V	normal,- 0.25pF,0.25pF
C827	2320778	Bottom	Q	5	0402C	Chipcap X7R 10% 16V 0402	10n	16V	normal,- 10%,10%
C834	2320536	Bottom	Q	5	0402C	Chipcap 5% NPO	10p	50V	normal,-5%,5%
C835	2320536	Top	R	8	0402C	Chipcap 5% NPO	10p	50V	normal,-5%,5%
C836	2320552	Top	R	8	0402C	Chipcap 5% NPO	47p	50V	normal,-5%,5%
C837	2320536	Bottom	S	8	0402C	Chipcap 5% NPO	10p	50V	normal,-5%,5%
C871	2320805	Bottom	W	6	0402C	CHIPCAP X5R 100N K 10V 0402	100n	10V	normal,- 10%,10%
D001	4341537	Bottom	F	5	SSOP8_P_0.50A	2XANALOG SWITCH 74LVC2G66 VSSOP8	~	~	~
D100	4377001	Bottom	L	8	CSP_240	UPP_WD2-V2.4 F741973F UBGA240	~	~	~
D135	4341425	Bottom	R	11	USMD14_2.433X2.1 1ABC_0.675	WHITE LED DRIVER LM2795TLX USMD14	~	~	~
D190	4370825	Bottom	N	8	uBGA168	UEMK 4.4 W-DOG ENA TO21 TFBGA168	~	~	~
D310	4341607	Bottom	I	11	uBGA40_64MB_4	FLASH 4MX16 1V8/1V8 VTFBGA44	4Mx16	~	~
D311	4341607	Bottom	K	11	uBGA40_64MB_4	FLASH 4MX16 1V8/1V8 VTFBGA44	4Mx16	~	~
D312	4341605	Bottom	J	8	WBGA_60_H0.9	SDRAM 8MX16 1.8V/1.8V WBGA60	8Mx16	~	~
D313	4341607	Bottom	M	11	uBGA40_64MB_4	FLASH 4MX16 1V8/1V8 VTFBGA44	4Mx16	~	~
D470	4341299	Bottom	F	13	SC70_5	1X1-IN BUFFER W/3ST 7SZ126 SC70-5	~	~	~
D550	4370991	Bottom	N	4	PBGA_N179	DSP TMS320DA250GHH-144 UBGA179	~	~	~
D551	4347165	Bottom	M	2	uBGA48_6.47X6.49	FLASH 1MX16 100NS 2.7V B3 UBGA48	1Mx16	~	~
D552	4341299	Bottom	N	2	SC70_5	1X1-IN BUFFER W/3ST 7SZ126 SC70-5	~	~	~
F381	5119019	Bottom	D	12	0603_FUSE	SM FUSE F 1.5A 32V 0603	1.5A	~	~
G190	4700131	Bottom	V	10	XH414_II02N	CELL CAPACITOR 0.01MAH 3V3	3V3	~	~
G701	4350387	Bottom	X	10	VCO_YKS1MNA370 0_A	VCO 3420-3980MHZ 2.7V 20MA	3420-3980MHz	~	~
L001	3203741	Bottom	E	3	0603_BLM	FERRITE BEAD 0R5 600R/ 100MHZ 0603	600R/100MHz	~	~
L002	3203741	Bottom	E	3	0603_BLM	FERRITE BEAD 0R5 600R/ 100MHZ 0603	600R/100MHz	~	~

Item	Code	Side	X	Y	Type	Description and value			
L003	3203741	Bottom	E	3	0603_BLM	FERRITE BEAD 0R5 600R/ 100MHZ 0603	600R/100MHz	~	~
L035	3203729	Bottom	B	7	0805_BLM21	FERRITE BEAD 0R05 220R/ 100M 0805	220R/100Mhz	~	normal,-,-
L036	3203729	Bottom	B	7	0805_BLM21	FERRITE BEAD 0R05 220R/ 100M 0805	220R/100Mhz	~	normal,-,-
L130	3646079	Top	T	4	0402L	CHIP COIL 47N J Q23/800M 0402	47nH	~	normal,-5%,5%
L131	3646079	Top	T	4	0402L	CHIP COIL 47N J Q23/800M 0402	47nH	~	normal,-5%,5%
L132	3646079	Top	W	6	0402L	CHIP COIL 47N J Q23/800M 0402	47nH	~	normal,-5%,5%
L133	3646079	Top	U	4	0402L	CHIP COIL 47N J Q23/800M 0402	47nH	~	normal,-5%,5%
L134	3646079	Top	W	6	0402L	CHIP COIL 47N J Q23/800M 0402	47nH	~	normal,-5%,5%
L135	3646079	Top	U	4	0402L	CHIP COIL 47N J Q23/800M 0402	47nH	~	normal,-5%,5%
L230	3203725	Bottom	H	4	FERRITE_0402	FERRITE BEAD 0R6 600R/ 100M 0402	600R/100MHz	~	~
L294	3640151	Bottom	S	11	CHOKE_ELL4LM100 MN	CHOKE 10U M 0.6A 0R18 4X4X1.8	10uH	~	normal,- 20%,20%
L295	3203741	Bottom	T	11	0603_BLM	FERRITE BEAD 0R5 600R/ 100MHZ 0603	600R/100MHz	~	~
L296	3203741	Bottom	R	10	0603_BLM	FERRITE BEAD 0R5 600R/ 100MHZ 0603	600R/100MHz	~	~
L300	3203741	Bottom	P	7	0603_BLM	FERRITE BEAD 0R5 600R/ 100MHZ 0603	600R/100MHz	~	~
L301	3203741	Bottom	N	7	0603_BLM	FERRITE BEAD 0R5 600R/ 100MHZ 0603	600R/100MHz	~	~
L302	3203741	Bottom	O	7	0603_BLM	FERRITE BEAD 0R5 600R/ 100MHZ 0603	600R/100MHz	~	~
L303	3203741	Bottom	E	7	0603_BLM	FERRITE BEAD 0R5 600R/ 100MHZ 0603	600R/100MHz	~	~
L330	3203741	Bottom	I	4	0603_BLM	FERRITE BEAD 0R5 600R/ 100MHZ 0603	600R/100MHz	~	~
L331	3203801	Bottom	I	4	0405_2_MATSU	CHIP BEAD ARRAY 2X1000R 0405	2x1000R/ 100MHz	~	-
L332	3203741	Bottom	I	4	0603_BLM	FERRITE BEAD 0R5 600R/ 100MHZ 0603	600R/100MHz	~	~
L381	3203705	Bottom	C	11	0805_FERRITE	FERRITE BEAD 42R/100MHZ 0805	42R/100MHz	~	~
L430	3203705	Bottom	G	12	0805_FERRITE	FERRITE BEAD 42R/100MHZ 0805	42R/100MHz	~	~
L431	3203741	Bottom	E	11	0603_BLM	FERRITE BEAD 0R5 600R/ 100MHZ 0603	600R/100MHz	~	~
L500	3646139	Bottom	L	4	0402L_POL2	CHIP COIL 120NH J Q8/ 100MHZ 0402	120nH	~	normal,-5%,+5%
L501	3645209	Bottom	L	2	COIL_0603CS	CHIP COIL 33N G Q40/ 250MHZ 0603	33nH	~	normal,-2%,2%
L502	3645209	Bottom	K	2	COIL_0603CS	CHIP COIL 33N G Q40/ 250MHZ 0603	33nH	~	normal,-2%,2%
L503	3646029	Bottom	L	5	0402_EJRF	CHIP COIL 39N J Q7/100MHZ 0402	39nH	~	normal,-5%,+5%

Item	Code	Side	X	Y	Type	Description and value			
L510	3646031	Bottom	L	7	0402_ELJRF	CHIP COIL 47N J Q7/100M 0402	47nH	~	normal,-5%,+5%
L511	3646031	Bottom	L	7	0402_ELJRF	CHIP COIL 47N J Q7/100M 0402	47nH	~	normal,-5%,+5%
L512	3646031	Bottom	L	7	0402_ELJRF	CHIP COIL 47N J Q7/100M 0402	47nH	~	normal,-5%,+5%
L603	3646047	Bottom	V	8	0402L	CHIP COIL 3N3 +-0N3 Q28/ 800M 0402	3n3H	~	normal,- 0n3,+0n3%
L604	3646047	Bottom	V	7	0402L	CHIP COIL 3N3 +-0N3 Q28/ 800M 0402	3n3H	~	normal,- 0n3,+0n3%
L606	3646055	Bottom	V	6	0402L	CHIP COIL 8N2 J Q28/ 800MHZ 0402	8n2H	~	normal,-5%,+5%
L607	3646055	Bottom	V	6	0402L	CHIP COIL 8N2 J Q28/ 800MHZ 0402	8n2H	~	normal,-5%,+5%
L608	3646005	Bottom	V	7	0402L	CHIP COIL 2N7+-0N3 Q29/ 800M 0402	2n7H	~	normal,-0n3,0n3
L609	3646005	Bottom	V	6	0402L	CHIP COIL 2N7+-0N3 Q29/ 800M 0402	2n7H	~	normal,-0n3,0n3
L701	3646027	Bottom	X	6	0402_ELJRF	CHIP COIL 33N J Q7/100MHZ 0402	33nH	~	normal,-5%,+5%
L702	3646027	Bottom	Y	6	0402_ELJRF	CHIP COIL 33N J Q7/100MHZ 0402	33nH	~	normal,-5%,+5%
L703	3646027	Bottom	X	6	0402_ELJRF	CHIP COIL 33N J Q7/100MHZ 0402	33nH	~	normal,-5%,+5%
L705	3646047	Bottom	V	8	0402L	CHIP COIL 3N3 +-0N3 Q28/ 800M 0402	3n3H	~	normal,- 0n3,+0n3%
L706	3646065	Bottom	W	8	0402L	CHIP COIL 12N J Q31/800M 0402	12nH	~	normal,-5%,5%
L707	3646067	Bottom	W	8	0402L	CHIP COIL 18N J Q29/800M 0402	18nH	~	normal,-5%,5%
L708	3646067	Bottom	V	8	0402L	CHIP COIL 18N J Q29/800M 0402	18nH	~	normal,-5%,5%
L712	3646053	Bottom	U	8	0402L	CHIP COIL 4N7 +-0N3 Q28/ 800M 0402	4n7H	~	normal,- 0n3,+0n3
L801	4551015	Bottom	R	5	COUPLER_LDC15D	DIR.COUP 897.5/1747.5/ 1880MHZ	897.5/1747.5/ 1880M	~	~
L805	3203705	Bottom	S	8	0805_FERRITE	FERRITE BEAD 42R/100MHZ 0805	42R/100MHz	~	~
L806	3646009	Bottom	T	8	0402L	CHIP COIL 10N J Q30/800M 0402	10nH	~	normal,-5%,5%
L807	3646059	Bottom	T	8	0402L	CHIP COIL 5N6 +-0N3 Q28/ 800M 0402	5n6H	~	normal,- 0n3,+0n3
L808	3646059	Bottom	R	5	0402L	CHIP COIL 5N6 +-0N3 Q28/ 800M 0402	5n6H	~	normal,- 0n3,+0n3
L809	3203705	Top	R	8	0805_FERRITE	FERRITE BEAD 42R/100MHZ 0805	42R/100MHz	~	~
N261	4341505 4341521	Bottom	T	10	USMD10_2.534X2.2 8X0.675	DC/DC 1.8V/1.5V LM2608-1.8 USMD10	~	~	~
N264	4341477	Bottom	P	2	USMD5_1.468X1.03 6	VREG 3.1V/150MA (LP3985- 3.1) USMD5	~	3.1V	~
N265	4341477	Bottom	K	6	USMD5_1.468X1.03 6	VREG 3.1V/150MA (LP3985- 3.1) USMD5	~	3.1V	~
N266	4341477	Bottom	M	6	USMD5_1.468X1.03 6	VREG 3.1V/150MA (LP3985- 3.1) USMD5	~	3.1V	~

Item	Code	Side	X	Y	Type	Description and value			
N267	4341773	Bottom	R	10	MSOP_8_H1.1	DC/DC CONV LM2788 1.8V 100MA MSOP8	~	~	~
N268	4341771	Bottom	O	2	SOT23_5_H1.2	REG 1.5V/150MA LP2085IM5X SOT23-5	~	1.5V	~
N301	4341535	Bottom	R	13	USMD_10_2.08X1.5 7	CURRENT SENSOR LM3819 USMD10	~	~	~
N330	4341221	Bottom	C	9	USMD9_AAB	AF AMP 0.4W/2.6V LM4890 USMD9	~	~	~
N430	4350289	Bottom	G	9	BT102_X_BLUETOOT H	BLUETOOTH LRB-2 MCM PHONE 26X13X2	~	~	~
N431	4219941	Bottom	F	12	SOT_363	TRX2+RX4 RN4906 N&P 4.7k/47k US6	~	~	~
N470	4341461	Bottom	F	13	USMD16_2.03X2.03	VREG & LEVEL SHIFT LP3928 USMD16	~	3-6V	~
N500	4341427	Bottom	K	3	HVQFN40	FM RECEIVER TEA5767HN LQFP40	~	~	~
N501	4341513	Bottom	K	5	PBGA_N80_MIRRO R	AUDIO CODEC W/AF AMP TLV320AIC23B	~	~	~
N550	4210371	Bottom	E	5	SOT_363	TRX2 UMF28 50V 0.1A SOT363	~	~	~
N551	4210371	Bottom	D	6	SOT_363	TRX2 UMF28 50V 0.1A SOT363	~	~	~
N552	4210371	Bottom	E	5	SOT_363	TRX2 UMF28 50V 0.1A SOT363	~	~	~
N601	4370867	Bottom	W	7	LFBGA_80	MJOELNER RF ASIC S2006 LFBGA80	~	~	~
N801	4350323	Bottom	R	7	PW_AMP_PA_HDE1 3A	PW AMP PF08125B GSM900/ 1800/1900	~	~	~
R001	1430796	Bottom	H	4	0402R	Resistor 5% 63mW	47k	~	normal,-5%,5%
R002	1430778	Bottom	G	4	0402R	Resistor 5% 63mW	10k	~	normal,-5%,5%
R003	1430804	Bottom	G	4	0402R	Resistor 5% 63mW	100k	~	normal,-5%,5%
R004	1430770	Bottom	E	3	0402R	Resistor 5% 63mW	4k7	~	normal,-5%,5%
R005	1825027	Bottom	E	3	0402_VAR	CHIP VARISTOR VWM5.6V VC15.5 0402	5.6V/15V/0.05J	~	-
R006	1825027	Bottom	E	3	0402_VAR	CHIP VARISTOR VWM5.6V VC15.5 0402	5.6V/15V/0.05J	~	-
R007	1430788	Bottom	F	5	0402R	Resistor 5% 63mW	22k	~	normal,-5%,5%
R008	1430788	Bottom	F	5	0402R	Resistor 5% 63mW	22k	~	normal,-5%,5%
R009	1430778	Bottom	F	5	0402R	Resistor 5% 63mW	10k	~	normal,-5%,5%
R010	1430778	Bottom	F	5	0402R	Resistor 5% 63mW	10k	~	normal,-5%,5%
R011	1430770	Bottom	F	4	0402R	Resistor 5% 63mW	4k7	~	normal,-5%,5%
R012	1430770	Bottom	F	4	0402R	Resistor 5% 63mW	4k7	~	normal,-5%,5%
R013	1430770	Bottom	F	4	0402R	Resistor 5% 63mW	4k7	~	normal,-5%,5%
R014	1430770	Bottom	F	4	0402R	Resistor 5% 63mW	4k7	~	normal,-5%,5%
R016	1430710	Bottom	C	7	0402R	Resistor 5% 63mW	22R	~	normal,-5%,5%
R018	1430142	Bottom	I	5	0603R	Chipres 0W06 J 0603	4R7	~	normal,-5%,+5%
R025	1430776	Bottom	K	4	0402R	Resistor 5% 63mW	8k2	~	normal,-5%,5%
R026	1430776	Bottom	K	4	0402R	Resistor 5% 63mW	8k2	~	normal,-5%,5%
R027	1430788	Bottom	K	4	0402R	Resistor 5% 63mW	22k	~	normal,-5%,5%
R028	1438701	Bottom	D	3	0402R	CHIPRES 0W06 1R J 0402	1R	~	normal,-5%,5%
R029	1438701	Bottom	D	3	0402R	CHIPRES 0W06 1R J 0402	1R	~	normal,-5%,5%
R030	1430784	Bottom	D	5	0402R	Resistor 5% 63mW	15k	~	normal,-5%,5%
R034	1430784	Bottom	D	5	0402R	Resistor 5% 63mW	15k	~	normal,-5%,5%

Item	Code	Side	X	Y	Type	Description and value			
R130	1430804	Bottom	M	10	0402R	Resistor 5% 63mW	100k	~	normal,-5%,5%
R132	1430762	Bottom	X	12	0402R	Resistor 5% 63mW	2k2	~	normal,-5%,5%
R133	1825133	Bottom	X	12	0402_VAR	CHIP VARISTOR VW14V VC50V 0402	14V/50V	~	-
R165	1430726	Bottom	R	12	0402R	Resistor 5% 63mW	100R	~	normal,-5%,5%
R171	1430726	Bottom	J	7	0402R	Resistor 5% 63mW	100R	~	normal,-5%,5%
R175	1430720	Bottom	R	11	0402R	Resistor 5% 63mW	56R	~	normal,-5%,5%
R177	1430720	Bottom	R	11	0402R	Resistor 5% 63mW	56R	~	normal,-5%,5%
R178	1430794	Bottom	Q	11	0402R	Resistor 5% 63mW	39k	~	normal,-5%,5%
R179	1430710	Bottom	E	12	0402R	Resistor 5% 63mW	22R	~	normal,-5%,5%
R180	1430718	Bottom	Q	11	0402R	Resistor 5% 63mW	47R	~	normal,-5%,5%
R181	1430718	Bottom	Q	11	0402R	Resistor 5% 63mW	47R	~	normal,-5%,5%
R191	1419003	Bottom	Q	10	1210_R	CHIPRES 0W5 0R22 J 1210	0R22	~	normal,-5%,5%
R217	1430145	Bottom	P	11	0402R	Chipres 0W06 100k F 200ppm 0402	100k	~	normal,-1%,1%
R218	1430804	Bottom	P	11	0402R	Resistor 5% 63mW	100k	~	normal,-5%,5%
R219	1430804	Bottom	P	11	0402R	Resistor 5% 63mW	100k	~	normal,-5%,5%
R220	1430804	Bottom	N	11	0402R	Resistor 5% 63mW	100k	~	normal,-5%,5%
R228	1430873	Bottom	M	7	0402R	CHIPRES 0W06 27K F 0402	27k	~	normal,-1%,1%
R229	1825033	Bottom	Q	3	0402_VAR	CHIP VARISTOR VW14V VC46V 0402	14V/46V	~	-
R230	4120011	Bottom	Q	2	uBGA5	ZDIX4 IP4043CX5 CA 14V2 10W CSP5	~	~	~
R263	1430690	Bottom	T	10	0402R	Chipres 0W06 jumper 0402	0R	~	normal,-,-
R269	1430693	Bottom	L	5	0402R	Chipres 0W06 5R6 J 0402	5R6	~	normal,-5%,5%
R270	1430693	Bottom	M	5	0402R	Chipres 0W06 5R6 J 0402	5R6	~	normal,-5%,5%
R271	1430786	Bottom	M	4	0402R	Resistor 5% 63mW	18k	~	normal,-5%,5%
R314	1430770	Bottom	N	12	0402R	Resistor 5% 63mW	4k7	~	normal,-5%,5%
R330	1430137	Bottom	N	10	0402R	CHIPRES 0W06 1K0 F 200PPM 0402	1k0	~	normal,-1%,1%
R332	1430137	Bottom	N	11	0402R	CHIPRES 0W06 1K0 F 200PPM 0402	1k0	~	normal,-1%,1%
R333	1825033	Bottom	C	12	0402_VAR	CHIP VARISTOR VW14V VC46V 0402	14V/46V	~	-
R334	1825033	Bottom	C	12	0402_VAR	CHIP VARISTOR VW14V VC46V 0402	14V/46V	~	-
R336	1430802	Bottom	C	7	0402R	Resistor 5% 63mW	82k	~	normal,-5%,5%
R337	1430776	Bottom	D	6	0402R	Resistor 5% 63mW	8k2	~	normal,-5%,5%
R340	1825033	Bottom	C	6	0402_VAR	CHIP VARISTOR VW14V VC46V 0402	14V/46V	~	-
R341	1825033	Bottom	C	6	0402_VAR	CHIP VARISTOR VW14V VC46V 0402	14V/46V	~	-
R342	1430142	Bottom	I	5	0603R	Chipres 0W06 J 0603	4R7	~	normal,-5%,+5%
R343	1430754	Bottom	N	11	0402R	Resistor 5% 63mW	1k0	~	normal,-5%,5%
R344	1430762	Bottom	N	11	0402R	Resistor 5% 63mW	2k2	~	normal,-5%,5%
R345	1430762	Bottom	O	11	0402R	Resistor 5% 63mW	2k2	~	normal,-5%,5%
R347	1430137	Bottom	N	11	0402R	CHIPRES 0W06 1K0 F 200PPM 0402	1k0	~	normal,-1%,1%
R348	1825033	Bottom	I	4	0402_VAR	CHIP VARISTOR VW14V VC46V 0402	14V/46V	~	-
R349	1825033	Bottom	I	4	0402_VAR	CHIP VARISTOR VW14V VC46V 0402	14V/46V	~	-

Item	Code	Side	X	Y	Type	Description and value			
R351	1825133	Bottom	J	3	0402_VAR	CHIP VARISTOR VWM14V VC50V 0402	14V/50V	~	-
R352	1825033	Bottom	I	4	0402_VAR	CHIP VARISTOR VW14V VC46V 0402	14V/46V	~	-
R353	1825033	Bottom	I	4	0402_VAR	CHIP VARISTOR VW14V VC46V 0402	14V/46V	~	-
R354	1825033	Bottom	T	12	0402_VAR	CHIP VARISTOR VW14V VC46V 0402	14V/46V	~	-
R355	1825033	Bottom	T	12	0402_VAR	CHIP VARISTOR VW14V VC46V 0402	14V/46V	~	-
R358	1430762	Bottom	O	11	0402R	Resistor 5% 63mW	2k2	~	normal,-5%,5%
R359	1430762	Bottom	N	11	0402R	Resistor 5% 63mW	2k2	~	normal,-5%,5%
R361	1430792	Bottom	O	11	0402R	Resistor 5% 63mW	33k	~	normal,-5%,5%
R367	1430792	Bottom	O	10	0402R	Resistor 5% 63mW	33k	~	normal,-5%,5%
R368	1430792	Bottom	O	11	0402R	Resistor 5% 63mW	33k	~	normal,-5%,5%
R383	1430762	Bottom	Q	13	0402R	Resistor 5% 63mW	2k2	~	normal,-5%,5%
R384	1430762	Bottom	Q	13	0402R	Resistor 5% 63mW	2k2	~	normal,-5%,5%
R385	4120011	Bottom	Q	13	uBGA5	ZDIX4 IP4043CX5 CA 14V2 10W CSP5	~	~	~
R402	1430812	Bottom	P	3	0402R	Resistor 5% 63mW	220k	~	normal,-5%,5%
R404	1820039	Bottom	O	12	0402_NTH5	NTC RES 47K J B=4050+ -3% 0402	47k	~	normal,-5%,5%
R430	1430690	Bottom	H	12	0402R	Chipres 0W06 jumper 0402	0R	~	normal,-,-
R433	1430762	Bottom	E	8	0402R	Resistor 5% 63mW	2k2	~	normal,-5%,5%
R434	1430796	Bottom	F	12	0402R	Resistor 5% 63mW	47k	~	normal,-5%,5%
R435	1430766	Bottom	G	12	0402R	Resistor 5% 63mW	3k9	~	normal,-5%,5%
R475	1430786	Bottom	H	5	0402R	Resistor 5% 63mW	18k	~	normal,-5%,5%
R476	1430804	Bottom	G	13	0402R	Resistor 5% 63mW	100k	~	normal,-5%,5%
R496	4120071	Bottom	H	6	uBGA8	ASIP EMIF03-SIM01 SIM FIL- TER BGA8	~	~	~
R500	1430718	Bottom	K	2	0402R	Resistor 5% 63mW	47R	~	normal,-5%,5%
R501	1430778	Bottom	K	2	0402R	Resistor 5% 63mW	10k	~	normal,-5%,5%
R502	1430710	Bottom	L	2	0402R	Resistor 5% 63mW	22R	~	normal,-5%,5%
R503	1430778	Bottom	L	2	0402R	Resistor 5% 63mW	10k	~	normal,-5%,5%
R504	1430804	Bottom	L	2	0402R	Resistor 5% 63mW	100k	~	normal,-5%,5%
R505	1430710	Bottom	K	2	0402R	Resistor 5% 63mW	22R	~	normal,-5%,5%
R506	1430792	Bottom	K	3	0402R	Resistor 5% 63mW	33k	~	normal,-5%,5%
R507	1430786	Bottom	K	2	0402R	Resistor 5% 63mW	18k	~	normal,-5%,5%
R508	1430778	Bottom	K	2	0402R	Resistor 5% 63mW	10k	~	normal,-5%,5%
R514	1430778	Bottom	K	2	0402R	Resistor 5% 63mW	10k	~	normal,-5%,5%
R515	1430778	Bottom	K	1	0402R	Resistor 5% 63mW	10k	~	normal,-5%,5%
R516	1430778	Bottom	K	1	0402R	Resistor 5% 63mW	10k	~	normal,-5%,5%
R528	1430792	Bottom	K	2	0402R	Resistor 5% 63mW	33k	~	normal,-5%,5%
R559	1430830	Bottom	A	8	0402R	Resistor 5% 63mW	1M0	~	normal,-5%,5%
R560	1430830	Bottom	A	8	0402R	Resistor 5% 63mW	1M0	~	normal,-5%,5%
R561	1430804	Bottom	P	4	0402R	Resistor 5% 63mW	100k	~	normal,-5%,5%
R562	1430804	Bottom	P	5	0402R	Resistor 5% 63mW	100k	~	normal,-5%,5%
R563	1430770	Bottom	M	3	0402R	Resistor 5% 63mW	4k7	~	normal,-5%,5%
R564	1430770	Bottom	M	3	0402R	Resistor 5% 63mW	4k7	~	normal,-5%,5%
R565	4120081	Bottom	A	7	uBGA_10_1.7X2.05	ASIP EMIF02-USB02 USB/ESD BGA8	~	~	~
R566	1430804	Bottom	E	4	0402R	Resistor 5% 63mW	100k	~	normal,-5%,5%

Item	Code	Side	X	Y	Type	Description and value			
R571	1430804	Bottom	M	4	0402R	Resistor 5% 63mW	100k	~	normal,-5%,5%
R574	4120101	Bottom	E	12	uBGA11_1.77X2.32	ASIP MMC-INTERFACE ESD FILT BGA11	~	~	~
R581	1430804	Bottom	N	6	0402R	Resistor 5% 63mW	100k	~	normal,-5%,5%
R582	1430726	Bottom	M	3	0402R	Resistor 5% 63mW	100R	~	normal,-5%,5%
R583	1430726	Bottom	M	3	0402R	Resistor 5% 63mW	100R	~	normal,-5%,5%
R584	1430804	Bottom	E	6	0402R	Resistor 5% 63mW	100k	~	normal,-5%,5%
R585	1430812	Bottom	E	6	0402R	Resistor 5% 63mW	220k	~	normal,-5%,5%
R587	1430788	Bottom	E	6	0402R	Resistor 5% 63mW	22k	~	normal,-5%,5%
R588	1430788	Bottom	E	5	0402R	Resistor 5% 63mW	22k	~	normal,-5%,5%
R589	1430804	Bottom	E	5	0402R	Resistor 5% 63mW	100k	~	normal,-5%,5%
R590	1430810	Bottom	D	6	0402R	Resistor 5% 63mW	180k	~	normal,-5%,5%
R591	1430788	Bottom	D	6	0402R	Resistor 5% 63mW	22k	~	normal,-5%,5%
R592	1430804	Bottom	E	6	0402R	Resistor 5% 63mW	100k	~	normal,-5%,5%
R594	1430788	Bottom	D	7	0402R	Resistor 5% 63mW	22k	~	normal,-5%,5%
R595	1430778	Bottom	M	3	0402R	Resistor 5% 63mW	10k	~	normal,-5%,5%
R596	1430778	Bottom	N	3	0402R	Resistor 5% 63mW	10k	~	normal,-5%,5%
R597	1430810	Bottom	E	5	0402R	Resistor 5% 63mW	180k	~	normal,-5%,5%
R598	1430778	Bottom	N	3	0402R	Resistor 5% 63mW	10k	~	normal,-5%,5%
R599	1430788	Bottom	E	5	0402R	Resistor 5% 63mW	22k	~	normal,-5%,5%
R600	1430788	Bottom	E	5	0402R	Resistor 5% 63mW	22k	~	normal,-5%,5%
R601	1430754	Bottom	I	7	0402R	Resistor 5% 63mW	1kO	~	normal,-5%,5%
R602	1430804	Bottom	I	7	0402R	Resistor 5% 63mW	100k	~	normal,-5%,5%
R603	1430804	Bottom	J	7	0402R	Resistor 5% 63mW	100k	~	normal,-5%,5%
R605	1430812	Bottom	Y	6	0402R	Resistor 5% 63mW	220k	~	normal,-5%,5%
R610	1430712	Bottom	V	5	0402R	Resistor 5% 63mW	27R	~	normal,-5%,5%
R612	1430754	Bottom	W	5	0402R	Resistor 5% 63mW	1kO	~	normal,-5%,5%
R616	1430144	Bottom	V	5	0603R	CHIPRES JUMPER 0603	0R	~	-
R620	1430690	Bottom	X	6	0402R	Chipres 0W06 jumper 0402	0R	~	normal,-,-
R623	1430726	Bottom	X	7	0402R	Resistor 5% 63mW	100R	~	normal,-5%,5%
R626	1430846	Bottom	W	5	0402R	Resistor 1% 63mW	2k7	~	normal,-1%,1%
R627	1430718	Bottom	I	7	0402R	Resistor 5% 63mW	47R	~	normal,-5%,5%
R630	1430718	Bottom	X	6	0402R	Resistor 5% 63mW	47R	~	normal,-5%,5%
R706	1430788	Bottom	X	8	0402R	Resistor 5% 63mW	22k	~	normal,-5%,5%
R707	1430784	Bottom	X	8	0402R	Resistor 5% 63mW	15k	~	normal,-5%,5%
R708	1430766	Bottom	X	8	0402R	Resistor 5% 63mW	3k9	~	normal,-5%,5%
R710	1430841	Bottom	X	9	0402R	Chipres 0W06 6k8 F 0402	6k8	~	normal,-1%,1%
R711	1430865	Bottom	Y	9	0402R	CHIPRES 0W06 5K6 F 0402	5k6	~	normal,-1%,1%
R715	1620033	Bottom	X	9	0404_R_SR	RES NETWORK 0W06 2X5K6 J 0404	2x5k6	~	normal,-5%,5%
R716	1620033	Bottom	X	9	0404_R_SR	RES NETWORK 0W06 2X5K6 J 0404	2x5k6	~	normal,-5%,5%
R717	1620105	Bottom	Y	9	MNR02_SR	RES NETWORK 0W06 2X2K2 J 0404	2x2k2	~	normal,-5%,5%
R720	1430726	Bottom	V	8	0402R	Resistor 5% 63mW	100R	~	normal,-5%,5%
R721	1430726	Bottom	V	8	0402R	Resistor 5% 63mW	100R	~	normal,-5%,5%
R725	1430730	Bottom	W	8	0402R	Resistor 5% 63mW	150R	~	normal,-5%,5%
R726	1430730	Bottom	V	8	0402R	Resistor 5% 63mW	150R	~	normal,-5%,5%
R730	1430693	Bottom	W	10	0402R	Chipres 0W06 5R6 J 0402	5R6	~	normal,-5%,5%
R731	1620507	Bottom	W	11	0404_RAC10	RES NETWORK 0W04 3DB ATT 0404	292R/17R6/292R	~	~
R732	1430700	Bottom	W	8	0402R	Resistor 5% 63mW	10R	~	normal,-5%,5%

Item	Code	Side	X	Y	Type	Description and value			
R733	1430700	Bottom	W	8	0402R	Resistor 5% 63mW	10R	~	normal,-5%,5%
R801	1430770	Bottom	S	5	0402R	Resistor 5% 63mW	4k7	~	normal,-5%,5%
R802	1430754	Bottom	T	5	0402R	Resistor 5% 63mW	1k0	~	normal,-5%,5%
R803	1430718	Bottom	S	5	0402R	Resistor 5% 63mW	47R	~	normal,-5%,5%
R806	1620513	Bottom	Q	8	0404_RAC10	RES NETWORK 0W04 5DB ATT 0404	178R5/30R4/ 178R5	~	~
R817	1430754	Bottom	R	8	0402R	Resistor 5% 63mW	1k0	~	normal,-5%,5%
R818	1430726	Bottom	R	8	0402R	Resistor 5% 63mW	100R	~	normal,-5%,5%
R819	1620507	Bottom	S	8	0404_RAC10	RES NETWORK 0W04 3DB ATT 0404	292R/17R6/292R	~	~
R820	1430754	Bottom	R	8	0402R	Resistor 5% 63mW	1k0	~	normal,-5%,5%
R821	1430726	Bottom	R	8	0402R	Resistor 5% 63mW	100R	~	normal,-5%,5%
R822	1430766	Bottom	T	8	0402R	Resistor 5% 63mW	3k9	~	normal,-5%,5%
R823	1430732	Bottom	T	8	0402R	Resistor 5% 63mW	180R	~	normal,-5%,5%
S130	5209001	Bottom	Y	12	BUTTON_EVQPUA02	SM SW TACT SPST 12V 50MA SIDE KEY	~	~	~
T701	4550191	Bottom	V	8	TRANS_LDB213	TRANSF BALUN 1800+- 100MHZ 2X1.25	~	~	~
T702	4550179	Bottom	W	10	TRANS_LDB15	BALUN TRANS 3.7GHZ+/- 300MHZ 0805	~	~	~
V101	4120061	Top	I	2	FC6_1.62X1.12	ASIP EMIF02-MIC02F1 2- LINE BGA6	~	~	~
V102	4120061	Top	R	8	FC6_1.62X1.12	ASIP EMIF02-MIC02F1 2- LINE BGA6	~	~	~
V103	4120061	Top	R	5	FC6_1.62X1.12	ASIP EMIF02-MIC02F1 2- LINE BGA6	~	~	~
V104	4120061	Top	R	10	FC6_1.62X1.12	ASIP EMIF02-MIC02F1 2- LINE BGA6	~	~	~
V105	4120061	Top	Y	8	FC6_1.62X1.12	ASIP EMIF02-MIC02F1 2- LINE BGA6	~	~	~
V106	4120061	Top	H	6	FC6_1.62X1.12	ASIP EMIF02-MIC02F1 2- LINE BGA6	~	~	~
V107	4120061	Top	H	9	FC6_1.62X1.12	ASIP EMIF02-MIC02F1 2- LINE BGA6	~	~	~
V108	4120061	Top	H	6	FC6_1.62X1.12	ASIP EMIF02-MIC02F1 2- LINE BGA6	~	~	~
V110	4120061	Top	H	8	FC6_1.62X1.12	ASIP EMIF02-MIC02F1 2- LINE BGA6	~	~	~
V111	4120061	Top	H	8	FC6_1.62X1.12	ASIP EMIF02-MIC02F1 2- LINE BGA6	~	~	~
V131	4110089	Bottom	J	12	SOT323	DIX2 BAV70W CC 70V .5A 4NS SOT323	~	~	~
V132	4110089	Bottom	I	12	SOT323	DIX2 BAV70W CC 70V .5A 4NS SOT323	~	~	~
V140	4864331	Top	X	10	LED_CL191	LED CL191TD3 605NM >83MCD 0603	~	~	~
V143	4864331	Top	U	8	LED_CL191	LED CL191TD3 605NM >83MCD 0603	~	~	~
V144	4864331	Top	X	6	LED_CL191	LED CL191TD3 605NM >83MCD 0603	~	~	~
V145	4864331	Top	T	4	LED_CL191	LED CL191TD3 605NM >83MCD 0603	~	~	~
V146	4864331	Top	G	8	LED_CL191	LED CL191TD3 605NM >83MCD 0603	~	~	~

Item	Code	Side	X	Y	Type	Description and value			
V147	4864331	Top	C	11	LED_CL191	LED CL191TD3 605NM >83MCD 0603	~	~	~
V148	4864331	Top	F	4	LED_CL191	LED CL191TD3 605NM >83MCD 0603	~	~	~
V149	4864331	Top	D	4	LED_CL191	LED CL191TD3 605NM >83MCD 0603	~	~	~
V151	4864427	Top	F	12	LED_CL_270	LED CL270SYG GRN>20MCD 90DEG 0603	~	~	~
V153	4864331	Top	U	11	LED_CL191	LED CL191TD3 605NM >83MCD 0603	~	~	~
V160	4860501	Top	K	3	LED_CL_430S_WA_ D_T	LED CL430SWD**RESERVED R0919**	~	~	~
V161	4860501	Top	L	3	LED_CL_430S_WA_ D_T	LED CL430SWD**RESERVED R0919**	~	~	~
V162	4860501	Top	N	3	LED_CL_430S_WA_ D_T	LED CL430SWD**RESERVED R0919**	~	~	~
V163	4860501	Top	P	3	LED_CL_430S_WA_ D_T	LED CL430SWD**RESERVED R0919**	~	~	~
V165	4219937	Bottom	R	11	SOT_363	TRX2 UMT1/PUMT1 P40V100MA SOT363	~	~	~
V166	4219937	Bottom	Q	11	SOT_363	TRX2 UMT1/PUMT1 P40V100MA SOT363	~	~	~
V167	4110475	Bottom	Q	11	EMD2	SCH DI RB521S-30 200MA 35V SOD523	~	~	~
V383	4113721	Bottom	C	9	CASE_457	TVS DI 1PMT16AT3 16V 175W PWRMITE	~	~	~
V500	4110965	Bottom	L	2	SOD_523	CAP.DI BB202 CT=2.5 FM OR8 SOD523	~	~	~
V501	4110965	Bottom	K	2	SOD_523	CAP.DI BB202 CT=2.5 FM OR8 SOD523	~	~	~
V601	4210100	Bottom	I	7	SOT323	Tr NPN 30V 100mA 100MHz SOT323	~	~	~
V801	4115821	Bottom	T	5	SOT323_H1.1	SCHDIX2 HSMS282C 15V <1PF SOT323	~	~	~
V802	4210171	Bottom	T	8	SC75	TR NE68119 ***RESERVED HDB12***	~	~	~
X003	5400247	Bottom	F	2	CONTACT_PAD_2.9 5X1.95	SM CONN VIBRA SPACER PAD 2.8X1.8	~	~	~
X004	5400247	Bottom	G	3	CONTACT_PAD_2.9 5X1.95	SM CONN VIBRA SPACER PAD 2.8X1.8	~	~	~
X005	5400247	Bottom	G	3	CONTACT_PAD_2.9 5X1.95	SM CONN VIBRA SPACER PAD 2.8X1.8	~	~	~
X006	5400247	Bottom	G	2	CONTACT_PAD_2.9 5X1.95	SM CONN VIBRA SPACER PAD 2.8X1.8	~	~	~
X007	5400247	Bottom	I	2	CONTACT_PAD_2.9 5X1.95	SM CONN VIBRA SPACER PAD 2.8X1.8	~	~	~
X008	5400247	Bottom	I	2	CONTACT_PAD_2.9 5X1.95	SM CONN VIBRA SPACER PAD 2.8X1.8	~	~	~
X009	5400247	Bottom	J	3	CONTACT_PAD_2.9 5X1.95	SM CONN VIBRA SPACER PAD 2.8X1.8	~	~	~
X010	5400247	Bottom	I	3	CONTACT_PAD_2.9 5X1.95	SM CONN VIBRA SPACER PAD 2.8X1.8	~	~	~
X011	5400247	Bottom	I	1	CONTACT_PAD_2.9 5X1.95	SM CONN VIBRA SPACER PAD 2.8X1.8	~	~	~

Item	Code	Side	X	Y	Type	Description and value			
X100	5409309	Bottom	W	11	TRACEABILITY_PAD	MODULE ID COMPONENT 2.8X1.8X0.3	~	~	~
X133	5469197	Top	J	2	MOLEX_54722_0168	SM CONN 2X8F P0.5 50V .5A PWB/PWB	~	~	~
X134	5400247	Bottom	N	13	CONTACT_PAD_2.95X1.95	SM CONN VIBRA SPACER PAD 2.8X1.8	~	~	~
X135	5400247	Bottom	N	13	CONTACT_PAD_2.95X1.95	SM CONN VIBRA SPACER PAD 2.8X1.8	~	~	~
X381	5409257	Bottom	P	13	LYNX_BATT_CONN_H8.3	SM LYNX BATT.CONN 3POL 12V 2A H8	~	~	~
X470	5409231	Bottom	I	5	SIM_CONN_2X3POL	SM SIM CONN 2X3POL P2.54	~	~	~
X550	5400219	Bottom	B	9	CONN_QX946_5S2	SM CONN USB MINI-B P0.8 90DEG	~	~	~
X553	5460045	Bottom	D	10	CON_AMP_C338610	SM CONN MMC 6POL SPR 30V 0.5A	~	~	~
X602	5429021	Bottom	U	4	COAX_CRS5001	SM CONN RF+SW 100V 1W 50R 2.2GHZ	~	~	~
Z130	4120035	Top	I	2	uBGA25_2.64X2.69	ASIP EMI/ESD10CH IP4041CX25 BGA25	~	~	~
Z517	3203725	Bottom	L	5	FERRITE_0402	FERRITE BEAD 0R6 600R/ 100M 0402	600R/100MHz	~	normal,-5%,5%
Z550	3203725	Bottom	B	8	FERRITE_0402	FERRITE BEAD 0R6 600R/ 100M 0402	600R/100MHz	~	~
Z601	4550177	Bottom	T	6	ANT_SW_LM_T118S1E2	ANT.SW+3SAW 990/1800/ 1900MHZ 7X5.3	880-960/1710- 1990MHz	~	~
Z602	4511283	Bottom	U	7	FILTER_SAW_SAFSD	SAW FILT 1842.5+-17.5MHZ 2.5X2	1842.5MHZ	~	~
Z603	4511325	Bottom	U	7	FILTER_SAW_SX_B195E	SAW FILT 1960+-30MHZ/4DB 2.5X2.0	1960MHz	~	~
Z604	4511287	Bottom	U	6	FILTER_SAW_SAFSD	SAW FILT 942.5+-17.5MHZ 3.5 2.5X2	942.5MHZ	~	~
Z701	4511289	Bottom	W	9	FILTER_SAW_SAFSD	SAW FILT 897.5+-17.5MHZ/ 3.5 2.5X2	897.5MHZ	~	~

[This page intentionally blank]